



# 77C SERIES Bronze Full Port Ball Valve

Job Name:	Contractor:
Job Location:	P.O. Number:
Engineer:	Representative:
Tag:	Wholesale Distributor:

## DESCRIPTION

The Apollo® 77C "Contractor Series" ball valve features dezincification resistant bronze body, premium "multi-fill" MPTFE seats and stem packing, and a "Solid Ball" design that delivers true full-port flow performance. Cast and machined in Apollo's South Carolina manufacturing plants utilizing proven ASTM materials.

## FEATURES

- Multi-Fill PTFE Seats & Seals
- Blow-out Proof Stem Design
- Adjustable Stem Packing
- Full-Port "Solid Ball" Design
- 100% Factory Tested

## APPROVALS

MSS SP-110 Compliant  
CRN: OC10908.5C

## PERFORMANCE RATING

Maximum Pressure: 600 psi CWP, 150 psi SWP  
Maximum Temperature: 500°F  
Vacuum service to 29 in. Hg

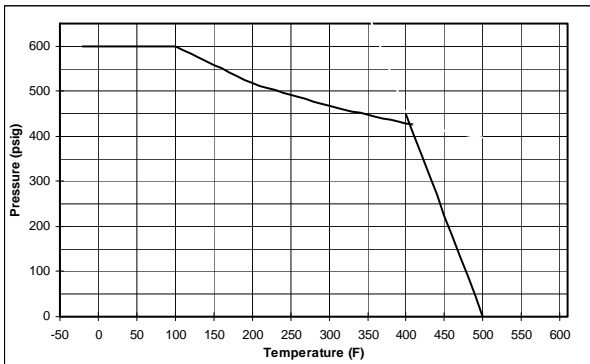

## STANDARD MATERIAL

Part Name	Material
Gland	ASTM B16 Brass
Nut	Zinc Plated Steel
Packing	MPTFE
Seat	MPTFE
Stem	ASTM B16 Brass
Ball	ASTM B16 Brass Chr Plt
Retainer	B584 Bronze or B16 Brass
Body	B584 Bronze
Handle	Zinc Plated Steel/Vinyl



## OPTIONS (For 1/4" to 2")

- (-A1) Oxygen Clean
- (-A3) Plain Grip
- (-01) Standard
- (-04) 2 1/4" Stem Extension
- (-07) Tee Handle
- (-10) S.S. Handle and Nut
- (-11) Thermo-Seal Insulating Tee Handle
- (-27) Locking Handle
- (-47) Oval Locking Handle
- (-92) Balancing Stop
- (-94) 2 1/4" Stem Extension and Balancing Stop
- (77C-140 & 77C-240 SERIES) S.S. Ball and Stem

## DIMENSIONS

Model Number	Size (in.)	Dimensions (in.)					Cv	Wt.*** (lbs.)
		A	B	C	D	E		
<b>NPT</b>								
77C-101-01	1/4"	0.37	0.95	1.97	1.76	3.74	5	0.6
77C-102-01	3/8"	0.37	1.07	2.09	1.76	3.74	7	0.5
77C-103-01	1/2"	0.50	1.15	2.25	1.79	3.74	16	0.6
77C-104-01	3/4"	0.75	1.32	2.65	2.00	4.88	36	1.0
77C-105-01	1"	1.00	1.53	3.07	2.19	4.88	68	1.8
77C-106-01	1 1/4"	1.25	2.04	4.08	3.13	7.06	125	4.4
77C-107-01	1 1/2"	1.50	2.12	4.23	3.29	7.06	177	4.6
77C-108-01	2"	2.00	2.43	4.85	3.83	7.06	389	8.1
77C-109-01	2 1/2"	2.50	3.12	6.37	4.51	8.06	503	16.2
<b>SOLDER</b>								
77C-202-01	3/8"	0.37	1.30	2.21	1.76	3.74	7	0.6
77C-203-01	1/2"	0.50	1.41	2.58	1.79	3.74	16	0.6
77C-204-01	3/4"	0.75	1.64	3.03	2.00	4.88	36	1.0
77C-205-01	1"	1.00	1.92	3.61	2.19	4.88	68	1.6
77C-206-01	1 1/4"	1.25	2.36	4.44	3.13	7.06	125	3.9
77C-207-01	1 1/2"	1.50	2.63	4.89	3.29	7.06	177	4.3
77C-208-01	2"	2.00	3.17	6.06	3.83	7.06	389	7.6
77C-209-01	2 1/2"	2.50	3.77	7.14	4.51	8.06	503	15.9

\*\*\* Weights based on

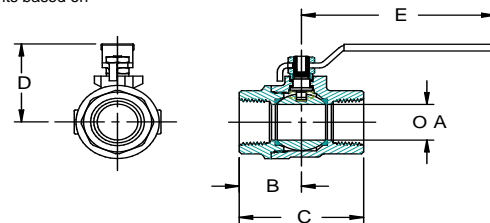

Standard Configuration

Conbraco Industries, Inc. 701 Matthews Mint Hill Rd. Matthews NC 28106 USA; [www.apollovalves.com](http://www.apollovalves.com); 704-841-6000  
This specification is provided for reference only. Conbraco reserves the right to change any portion of this specification without notice and without incurring obligation to make such changes to Conbraco products previously or subsequently sold.