



40-200 SERIES FIRE HYDRANT BACKFLOW METER

Job Name:	Contractor:
Job Location:	P.O. Number:
Engineer:	Representative:
Tag:	Wholesale Distributor:

DESCRIPTION

The Apollo Series 40-205-FHB Fire Hydrant Backflow Meter shall measure potable water from a fire hydrant or other non-permanent installation. At the same time it shall protect against backflow by either back-pressure or back-siphonage from a cross-connection between a potable water system and substances that are non-health or health hazards. The unit shall consist of a 3/4" Short Water Meter, 1" 40-205 RP device, 1" resilient-seated full port ball valve with locking device, 2 1/2" – 7 1/2" NST threaded hose couplings, strainer on inlet of meter and adjustable support rod assembly.

OPERATION

The Fire Hydrant Backflow Meter is connected directly to a fire hydrant with a 2 1/2" – 7 1/2" NST fire hose female swivel coupling. The device operates like a standard Reduced Pressure device except the flow through the device is measured by a Water Meter connected to the inlet of the backflow preventer. Support rod assembly is adjustable to accommodate fire hydrants at different heights from the ground.

FEATURES

- Normal operating flow range 2 – 30 GPM
- Accuracy 100% ± 1.5% of actual thruput
- Low flow registration 95% at 1/2 GPM
- Maximum pressure loss 11.0 PSI at 30 GPM
- Maximum operating pressure 150 PSI
- Measuring element oscillating piston
- Register is straight reading, hermetically sealed magnetic drive
- Tamperproof locking system inside the meter
- 2 1/2" – 7 1/2" NST fire hose swivel couplings – female inlet, male outlet
- Maximum rate listed is for intermittent flow only. Maximum continuous flow rate as specified by AWWA is 15 GPM
- Designed, manufactured, assembled and tested in South Carolina, USA

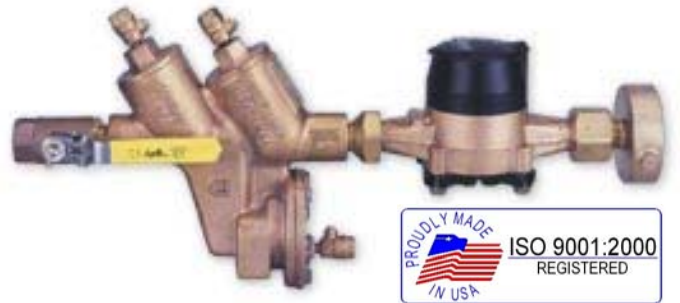

MATERIAL SPECIFICATIONS

Part Name	Material
Meter Maincase	Bronze
Maincase Bottom Plate	Bronze
Measuring Chamber	Rocksyn
Gears	Molded Plastic
Magnets	Alnico
Trim & Casing Bolts	Stainless Steel
Strainer	Thermoplastic

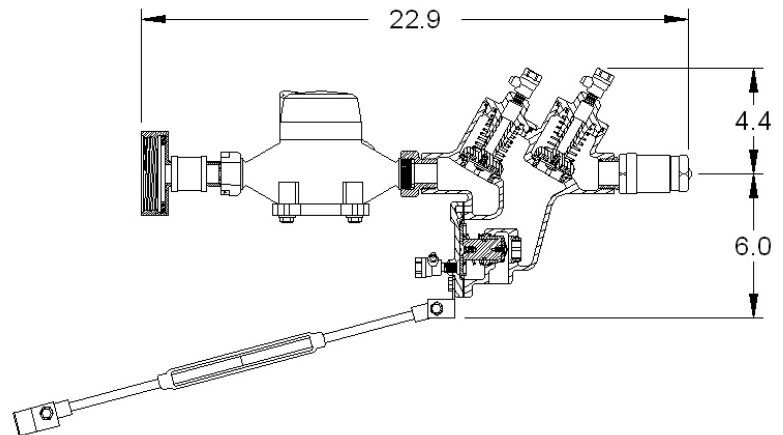

DIMENSIONS (in.) – WEIGHTS (lbs.)

Net Weight	24.1
Shipping Weight	27.6

ORDERING INFORMATION

40-205-FHB	(meter in cu. ft.)
40-205-FHBG	(meter in gallons)