

In-Line Check Valves

TABLE OF CONTENTS

Check Valve Numbering System3
Protection Against Reverse Flow4
61-100 Series5
61-200 Series6
61-500 / 61-6007
61-700 Mini Check Valves8
70-100-BC Series8
62-100 Series9
62-500 Series10
Repair Kits Available.....11

Warranty and Limitations of Liability

Conbraco Industries, Inc. warrants, to its initial purchaser only, that its products which are delivered to this initial purchaser will be of the kind described in the order or price list and will be free of defects in workmanship or material for a period of TWO years from the date of delivery to you, our initial purchaser.

Should any failure to conform to this warranty appear within one year after the date of the initial delivery to our initial purchaser, Conbraco will, upon written notification thereof and substantiation that the goods have been stored, installed, maintained and operated in accordance with Conbraco's recommendations and standard industry practice, correct such defects by suitable repair or replacement at Conbraco's own expense.

THIS WARRANTY IS EXCLUSIVE AND IS IN LIEU OF ANY IMPLIED WARRANTY OF MERCHANTABILITY, FITNESS FOR A PARTICULAR PURPOSE OR OTHER WARRANTY, WHETHER EXPRESS OR IMPLIED, EXCEPT THE WARRANTY OF TITLE AND AGAINST PATENT INFRINGEMENT. Correction of non-conformities, in the manner and for the period of time provided above, shall constitute fulfillment of all liabilities of Conbraco to our initial purchaser, with respect to the goods, whether based on contract, negligence, strict tort or otherwise. It is the intention of Conbraco Industries, Inc. that no warranty of any kind, whether express or implied shall pass through our initial purchaser to any other person or corporation.

LIMITATION OF LIABILITY: Conbraco Industries, Inc. SHALL NOT UNDER ANY CIRCUMSTANCES BE LIABLE FOR SPECIAL OR CONSEQUENTIAL DAMAGES SUCH AS, BUT NOT LIMITED TO, DAMAGE TO LOSS OF OTHER PROPERTY OR EQUIPMENT, LOSS OF PROFITS OR REVENUE, COST OF CAPITAL, COST OF PURCHASED OR REPLACEMENT GOODS, OR CLAIMS OF CUSTOMERS OF OUR INITIAL PURCHASER. THE REMEDIES OF OUR INITIAL PURCHASER, AND ALL OTHERS, SET FORTH HEREIN, ARE EXCLUSIVE, AND THE LIABILITY OF CONBRACO WITH RESPECT TO SAME SHALL NOT, EXCEPT AS EXPRESSLY PROVIDED HEREIN, EXCEED THE PRICE OF THE CONBRACO GOODS UPON WHICH SUCH LIABILITY IS BASED.

Check Valve Numbering System

Spring Loaded Check Valves Extend System Life

In any liquid or gas system where reverse flow cannot be tolerated, a quick-responding check valve is a necessity. Check valves that close slowly permit flow reversal to occur in the line which can cause severe mechanical shock. As the valve finally seats, high peak pressure pulses and shock waves are generated on the downstream side due to the media being forced to a sudden stop. Upstream, the momentum is not restricted which can create voids in the flow, filling with air or vapor to cause additional, lower frequency shock waves.

These shock waves added together are known as water hammer. It can cause extensive damage or failure to pipelines, gaskets, supports, hardware and equipment. The result can be expensive, troublesome, even dangerous.

With Conbraco's spring loaded 61 and 62 Series check valves, the potential for water hammer is greatly reduced since the check returns to its seat before flow velocity reaches zero.

Broad Range of Applications

Conbraco 61 and 62 Series in-line check valves are at home in applications from residential boilers to tough process systems, including:

- Evaporators
- Boiler Feed
- Water Lines
- Steam Lines
- Cookers
- Chiller Systems
- Steam Tracer Lines
- Salt Water Injection
- Rubber/Plastic Presses
- Autoclaves
- Sterilizers
- Air and Gas Lines
- Metering Pumps
- Casing Vents
- Condensate Return Lines
- Chemical Lines

Industries where Conbraco's in-line check valves are used include Pulp & Paper, Chemical Processing, Agrichemical, Rubber, Petroleum, Primary Metals, Mining, Power Generation, Textiles, Food and Beverage, Building Construction and Maintenance.

Check Valve Numbering System

6X-XXX-XX

| Type | Check | Spring Type | Size | Options |
|-----------|--------------------------------------|-------------------------------|------------|-----------------------------------|
| 1 - Brass | 1 - Ball Cone (NPT-F x F) | 0 - .5 psig Cracking Pressure | 1 - 1/4" | 01 - Standard |
| 2 - SS | 2 - Ball Cone (NPT-M x F) | 2 - .2 psig Cracking Pressure | 2 - 3/8" | 17 - Satin Chrome Plated |
| | 5 - Soft Seat (NPT-F x F) | | 3 - 1/2" | 21 - BSPP Thread |
| | 6 - Soft Seat (Sweat F x F) | | 4 - 3/4" | 57 - Oxygen Cleaned |
| | 9 - Soft Seat Repair Kit (EPDM only) | | 5 - 1" | A1 - Less Spring |
| | 0 - Ball Cone Repair Kit | | 6 - 1 1/4" | A8 - No Pipe Thread Retainer End |
| | | | 7 - 1-1/2" | B1 - Buna-N Seat (Soft Seat Only) |
| | | | 8 - 2" | E05 - 5 psig Opening Pressure* |
| | | | 9 - 2-1/2" | E10 - 10 psig Opening Pressure* |
| | | | 0 - 3" | V1 - Viton® |

*Available in 1/4" through 1" Only.
(Note: Not all combinations are available. Contact Customer Service for verification.)

Not recommended for use with reciprocating pumps and similar applications which may induce repetitious vibrations. Low flow rates which do not fully open the valve, may result in undesirable noise and premature valve failure. Upstream flow disturbances, which create turbulence, may also result in rapid wear. Therefore, it is recommended that a minimum of 10 diameters of straight pipe be provided between the check valve and any upstream flow disturbances such as pumps, control valves, elbows, etc. It is also recommended that a minimum of 2 diameters of straight pipe be allowed downstream of the valve outlet.

Protection Against Reverse Flow

Conbraco In-Line Check Valves Provide Fast, Dependable Protection Against Reverse Flow

Conbraco's in-line check valves set the standard for compact, economical protection against reverse flow. They provide reliable service in liquids or gases at various temperature and pressure combinations.

Conbraco check valves are rated 400 psig CWP, cold non-shock. Their straight-through configuration minimizes changes in flow velocity.

Because of their simple design, they're versatile and easy to maintain.

Choose Bronze Or Stainless Steel

Series 61 check valves feature bronze body construction and are available in sizes 1/4" to 3" for use with water, oil, air and inert gases.

Series 62 model in stainless steel with investment cast body are sized from 1/4" to 2" for use in more severe applications and corrosive environments.

Both come equipped with 316 stainless steel springs. All wetted parts are bronze/brass (61 Series) or stainless steel (62 Series).

Spring Assisted Closing

Conbraco's 61 and 62 Series feature short check travel and spring assisted closing. This ensures the valve closes quickly, before reversal of flow, helping to eliminate water hammer, its associated noise, and damage to piping and machinery.

Tight... Or Bubble Tight

Patented Conbraco Ball Cone® check valves (61-100, 61-200 and 62-100) feature a tight-sealing RPTFE ball-shaped check which seats against the conical interior face of the valve's metal retainer. This simple design provides exceptional resistance to wear and corrosion. Seat tightness to MSS-SP80. (Liquids: 10 ml/hr/inch, Gasses: 1 ml SCF/hr/inch.

But where even tighter sealing is required, choose the 61-500 or 61-600, featuring EPDM (elastomer) seat or 62-500, featuring a Fluorocarbon (Viton®) seat, for a bubble-tight seal. A Buna-N seat is optional.

Low Cracking Pressure

Conbraco's standard 61 and 62 Series checks operate at low cracking pressures. An extra-light-spring version of the valve is available as an option. A 5-pound or 10-pound cracking pressure spring is also available on models through 1".

Use In Any Position

Horizontal, vertical or upside down, Conbraco's in-line checks operate in any orientation, though vertical orientation with upward flow is best where frequent opening and closing cycles occur. This saves you time and money, eliminating the need to stock separate vertical and horizontal-operating valves. It also makes new or replacement installation less of a headache.

Quality Built In America

All Conbraco check valves are produced in the U.S. at ISO 9001 registered manufacturing facilities to assure integrity of design and the highest level of performance.

This brochure should provide you with all the information necessary to help you select the right Conbraco in-line check valve for your application. However, if you need more information, the name of your nearest Conbraco distributor or would like to place an order, please contact: Conbraco Industries, Inc. Customer Service, Phone: (704) 841-6000; Fax: (704) 841-6020.

61 Series Bronze Ball Cone® Check Valves

Female x Female Threaded 1/4" through 3"

Well-suited for a broad range of applications, including 125 psig saturated steam. The rugged bronze body and RPTFE ball check provide reliable, patented protection against reverse flow.

Features

Unique (U.S. Patent # 4,172,465) design provides tight shutoff in reverse flow conditions. It is spring-loaded for fast seating action and center guided so that radial alignment is never needed. Straight-through flow minimizes velocity change. Like all Conbraco in-line check valves, it is rated 400 psig CWP, cold non-shock. Tight to MSS.SP80



Materials of Construction

| | | |
|---|------------|--------------------------------------------------------------------|
| 1 | Body | Bronze - ASTM B584, UNS Alloy C84400 |
| 2 | Retainer | Brass - ASTM B16, (1/4" - 1") Bronze - ASTM B584, (1 1/4" - 3") |
| 3 | Ball Check | RPTFE - Reinforced Teflon(tm) |
| 4 | Guide | Brass - ASTM B16 |
| 5 | Spring | Steel - AISI 316 Stainless Steel |

Flow Rate (C_v)

GPM=gallons per minute
all at 1 psi pressure differential

| Size | GPM |
|--------|------|
| 1/4" | 0.85 |
| 3/8" | 1.21 |
| 1/2" | 1.4 |
| 3/4" | 3.53 |
| 1" | 6 |
| 1-1/4" | 44 |
| 1-1/2" | 65 |
| 2" | 81 |
| 2-1/2" | 175 |
| 3" | 265 |

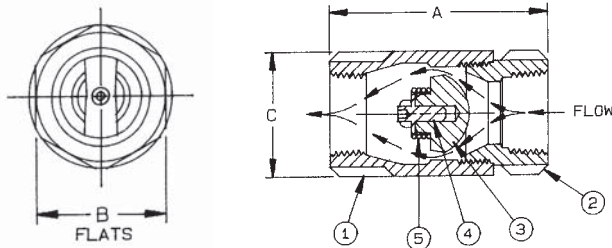

Dimensional Specifications

| Number | Size (in.) | A | B | C | Wt./100 |
|-----------|------------|------|------|------|---------|
| 61-101-01 | 1/4 | 2.06 | 1.12 | 1.12 | 38 |
| 61-102-01 | 3/8 | 2.12 | 1.12 | 1.12 | 38 |
| 61-103-01 | 1/2 | 2.31 | 1.12 | 1.12 | 38 |
| 61-104-01 | 3/4 | 2.87 | 1.37 | 1.50 | 75 |
| 61-105-01 | 1 | 3.50 | 1.75 | 1.93 | 145 |
| 61-106-01 | 1-1/4 | 4.18 | 2.12 | 2.37 | 275 |
| 61-107-01 | 1-1/2 | 4.93 | 2.50 | 2.81 | 394 |
| 61-108-01 | 2 | 6.00 | 3.00 | 3.68 | 630 |
| 61-109-01 | 2-1/2 | 7.00 | 3.50 | 4.50 | 1400 |
| 61-100-01 | 3 | 8.12 | 4.12 | 5.31 | 1665 |

RPTFE Ball Check

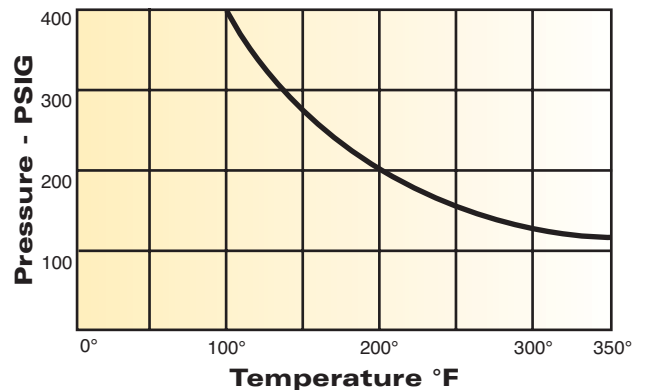

61-200 Series Ball Cone[®] Check Valves



Flow Rate (Cv)
GPM=gallons per minute
all at 1 psi pressure differential

| Size | GPM |
|--------|------|
| 1/4" | 0.85 |
| 3/8" | 1.21 |
| 1/2" | 1.4 |
| 3/4" | 3.53 |
| 1" | 6 |
| 1-1/4" | 44 |
| 1-1/2" | 65 |
| 2" | 81 |

Male x Female Threaded 1/4" through 2"

Ideally suited for a broad range of applications, including 125 psig saturated steam. The rugged bronze body and RPTFE ball check provide reliable, patented protection against reverse flow.

Features

Unique (U.S. Patent # 4,172,465) design provides tight shutoff in reverse flow conditions. It is spring-loaded for fast seating action and center guided so that radial alignment is never needed. Straight-through flow minimizes velocity change. Like all Conbraco in-line check valves, it is rated 400 psig CWP, cold non-shock. Tight to MSS.SP80

Materials of Construction

| | | |
|---|------------|--------------------------------------------------------------------|
| 1 | Body | Bronze - ASTM B584, UNS Alloy C84400 |
| 2 | Retainer | Brass - ASTM B16, (1/4" - 1") Bronze - ASTM B584, (1-1/4" - 2") |
| 3 | Ball Check | RPTFE - Reinforced Teflon™ |
| 4 | Guide | Brass - ASTM B16 |
| 5 | Spring | Steel - AISI 316 Stainless Steel |

RTFE Ball Check

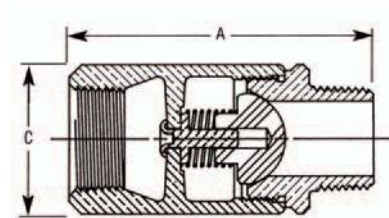
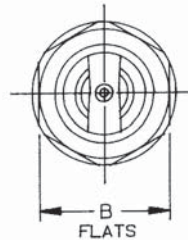
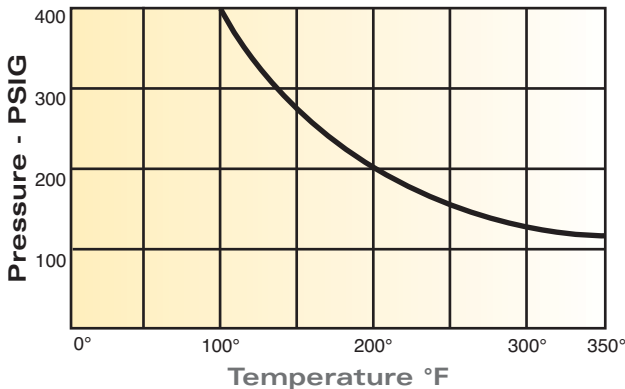

Dimensional Specifications

| Number | Size (in.) | A | B | C | Wt./100 |
|-----------|------------|------|------|------|---------|
| 61-201-01 | 1/4 | 2.38 | 1.12 | 1.12 | 38 |
| 61-202-01 | 3/8 | 2.38 | 1.12 | 1.12 | 38 |
| 61-203-01 | 1/2 | 2.56 | 1.12 | 1.12 | 38 |
| 61-204-01 | 3/4 | 3.12 | 1.37 | 1.50 | 75 |
| 61-205-01 | 1 | 3.87 | 1.75 | 1.93 | 145 |
| 61-206-01 | 1-1/4 | 4.44 | 2.12 | 2.37 | 275 |
| 61-207-01 | 1-1/2 | 5.18 | 2.50 | 2.81 | 394 |
| 61-208-01 | 2 | 6.50 | 3.00 | 3.68 | 630 |

61-500 / 61-600 Series Bronze Check Valves

Female x Female Threaded 1/4" - 2" Female x Female Sweat End 1/2" - 2"

Ideally suited for hydronic heating and other low flow applications, since seat disc and EPDM soft seat are less prone to vibration. The rugged bronze body and check provide reliable protection against reverse flow.

Features

The 61-500/61-600 features an EPM soft seat for bubble tight shutoff, reduced noise and less vibration. It is spring-loaded for fast seating action and center guided so that radial alignment is never needed. Straight-through flow minimizes velocity change. The spring is fully protected from the flow stream, helping extend life of the valve. A light spring is available as an option. It is rated 400 psig CWP, cold non-shock; Maximum Temperature 250°F.

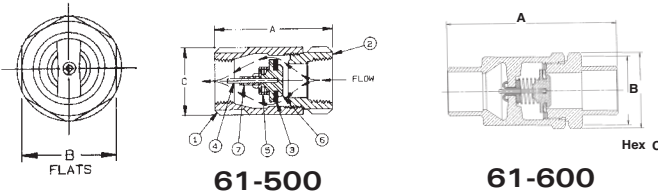

61-500



61-600

Materials of Construction

| | | |
|---|-----------|--------------------------------------|
| 1 | Body | Bronze - ASTM B584, UNS Alloy C84400 |
| 2 | Retainer | Brass - ASTM B16 (1/4" - 1") |
| 3 | Seat | EPDM |
| 4 | Guide Pin | Steel - AISI 420 Stainless Steel |
| 5 | Spring | Steel - AISI 316 Stainless Steel |
| 6 | Check | Brass - ASTM B16 |
| 7 | Guide | Brass - ASTM B16 |

61-500 Dimensional Specifications

| Number | Size (in.) | A | B | C | Wt./100 |
|-----------|------------|------|------|------|---------|
| 61-501-01 | 1/4 | 2.31 | 1.12 | 1.12 | 38 |
| 61-502-01 | 3/8 | 2.31 | 1.12 | 1.12 | 38 |
| 61-503-01 | 1/2 | 2.31 | 1.12 | 1.12 | 38 |
| 61-504-01 | 3/4 | 2.87 | 1.37 | 1.50 | 75 |
| 61-505-01 | 1 | 3.50 | 1.75 | 1.93 | 145 |
| 61-506-01 | 1-1/4 | 4.18 | 2.12 | 2.37 | 275 |
| 61-507-01 | 1-1/2 | 4.93 | 2.50 | 2.81 | 394 |
| 61-508-01 | 2 | 6.00 | 3.00 | 3.68 | 630 |

61-600 Dimensional Specifications

| Number | Size (in.) | A | B | C | Wt./100 |
|-----------|------------|------|------|------|---------|
| 61-603-01 | 1/2 | 2.75 | 1.12 | 1.25 | 38 |
| 61-604-01 | 3/4 | 3.68 | 1.50 | 1.62 | 75 |
| 61-605-01 | 1 | 4.50 | 1.93 | 2.12 | 145 |
| 61-606-01 | 1-1/4 | 6.11 | 2.13 | 2.38 | 330 |
| 61-607-01 | 1-1/2 | 6.87 | 2.50 | 2.81 | 610 |
| 61-608-01 | 2 | 7.46 | 3.38 | 3.75 | 1010 |

Flow Rate (C_v) GPM=gallons per minute all at 1 psi pressure differential

| 61-500 | | 61-600 | |
|--------|------|--------|------|
| Size | GPM | Size | GPM |
| 1/4" | 0.47 | 1/2" | 2.20 |
| 3/8" | 1.57 | 3/4" | 4.78 |
| 1/2" | 2.2 | 1" | 6 |
| 3/4" | 4.78 | 1-1/4" | 44 |
| 1" | 6 | 1-1/2" | 65 |
| 1 1/4" | 44 | 2" | 81 |
| 1 1/2" | 65 | | |
| 2" | 81 | | |

EPDM Seat

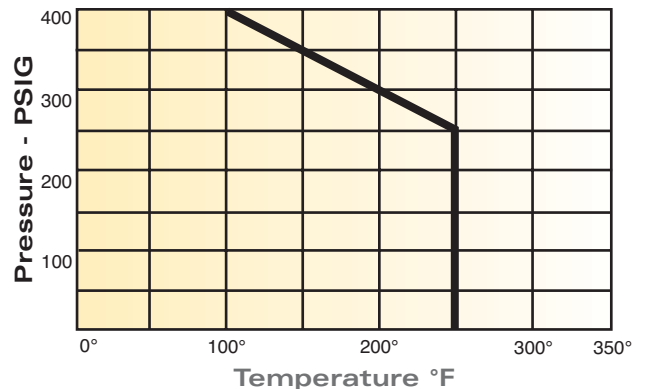

61-700 Series Mini Check Valves & 70-100-BC Unidirectional Ball Valves

Female x Female Threaded 1/4" through 1"

Ideally suited for cold water, air, and some non-hazardous gases and oils. Check compatibility with intended usage.

Features

The 61-700 operates on horizontal or vertical flow (up). It is spring-loaded for fast seating action. It does not generate hammering and has been air tested for leakage. It is rated at 250 PSIG CWP with a maximum temperature of 180°F.



Female x Female Threaded 1/2" through 2"

The 70-100-BC Series ball valve combines two functions in a single design: positive shut-off and bubble-tight check capabilities. The BC Series is a unidirectional version of the industry-standard Apollo 70 Series ball valve. An easy flow design and superior check valve make these valves a smart choice for water or air in OEM applications or mechanical systems.

Features

Blowout-proof stems. RPTFE seats and stuffing box ring. Adjustable packing gland. Chromium-plated ball. Positive shut-off and bubble-tight check capability.

Materials of Construction

| | | |
|---|----------------|------------------------------|
| 1 | Body | Brass, ASTM B16 |
| 2 | Check Assembly | Acetal/Brass/Silicone/Buna-N |
| 3 | Spring | Stainless Steel 302 |

Materials of Construction

| | | |
|----|--------------------|----------------------------|
| 1 | Body | B584-C84400 |
| 2 | Retainer | B16 (1/2"-1") |
| | | B584-C84400 (1-1/4"-2") |
| 3 | Ball | B16 Chrome Plated |
| 4 | Check Valve Insert | Acetal |
| 5 | Stem | B16 |
| 6 | Gland Nut | B16 |
| 7 | Lever and Grip | Steel, Zinc-plated w/vinyl |
| 8 | Lever Nut | Steel, Zinc-plated |
| 9 | O-Ring | Buna-N |
| 10 | Seat (2) | Reinforced TFE |
| 11 | Body Seal | TFE (1-1/4" - 2") |
| 12 | Stem Packing | Reinforced TFE |
| 13 | Stem Bearing | Reinforced TFE |
| 14 | Seal | EPDM (1/2") |
| 15 | Retaining Ring | Spring Steel (1/2") |

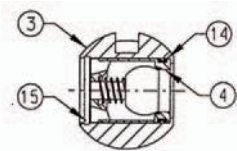
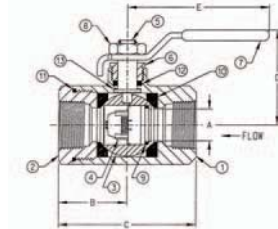
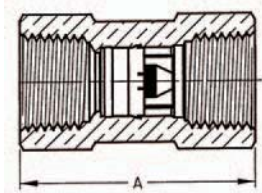
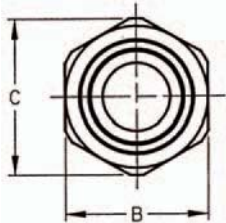

Dimensional Specifications

| Number | Size (in.) | A | B | C | Wt./100 |
|-----------|------------|------|------|------|---------|
| 61-701-01 | 1/4 | 1.72 | 0.81 | 0.92 | 22 |
| 61-702-01 | 3/8 | 1.79 | 0.93 | 1.05 | 29 |
| 61-703-01 | 1/2 | 2.02 | 1.06 | 1.17 | 38 |
| 61-704-01 | 3/4 | 2.50 | 1.25 | 1.40 | 54 |
| 61-705-01 | 1 | 2.95 | 1.62 | 1.76 | 110 |

Dimensional Specifications

| Number | Size | A | B | C | D | E | Wt./100 |
|-----------|--------|------|------|------|------|------|---------|
| 70-103-BC | 1/2" | 0.50 | 1.12 | 2.25 | 1.80 | 3.87 | 0.63 |
| 70-104-BC | 3/4" | 0.68 | 4.50 | 3.00 | 2.12 | 4.87 | 1.33 |
| 70-105-BC | 1" | 0.87 | 1.68 | 3.37 | 2.25 | 4.87 | 1.77 |
| 70-106-BC | 1 1/4" | 1.00 | 2.00 | 4.00 | 2.73 | 5.50 | 3.29 |
| 70-107-BC | 1 1/2" | 1.25 | 2.18 | 4.37 | 3.09 | 8.00 | 4.63 |
| 70-108-BC | 2" | 1.50 | 2.34 | 4.68 | 3.28 | 8.00 | 6.01 |

Flow Rate (Cv)
GPM=gallons per minute
all at 1 psi pressure differential

| Size | GPM |
|------|-------|
| 1/4" | 0.78 |
| 3/8" | 1.81 |
| 1/2" | 5.13 |
| 3/4" | 10.51 |
| 1" | 14.25 |

RTEFE Seats

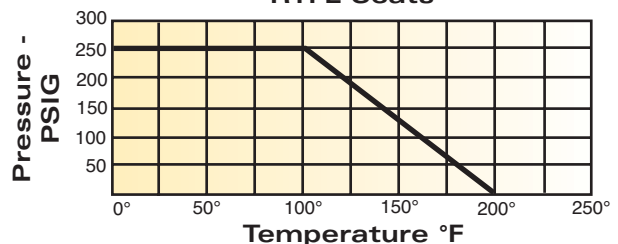

62 Series Stainless Steel Ball Cone® Check Valves

Female x Female Threaded 1/4" through 2"

The 62-100 Series is uniquely suited for applications in corrosive environments, including chemical processing, pulp and paper and other process industries. The rugged stainless steel body and RPTFE ball check provide reliable, patented protection against reverse flow.

Features

Unique (U.S. Patent # 4,172,465) design provides tight shutoff in reverse flow conditions. The body of the valve is investment cast stainless steel for longer life in severe environments. It is spring-loaded for fast seating action and center guided so that radial alignment is never needed. Straight-through flow minimizes velocity change. It is rated 400 psig CWP, cold non-shock; 125 psig saturated steam. Tight to MSS.SP80



Materials of Construction

| | | |
|---|------------|--------------------------------------------------------------------------------------------|
| 1 | Body | Stainless Steel - ASTM A351, CF8M |
| 2 | Retainer | Stainless Steel - ASTM A276, 316 (1/4"-1") Stainless Steel - ASTM A351,CF8M (1 1/4"-2") |
| 3 | Ball Check | RPTFE - Reinforced Teflon(tm) |
| 4 | Guide | Stainless Steel - ASTM A276, 316 |
| 5 | Spring | Steel - AISI 316 Stainless Steel |

Flow Rate (C_v)

GPM=gallons per minute
all at 1 psi pressure differential

| Size | GPM |
|--------|------|
| 1/4" | 0.85 |
| 3/8" | 1.21 |
| 1/2" | 1.40 |
| 3/4" | 3.53 |
| 1" | 6.00 |
| 1-1/4" | 44 |
| 1-1/2" | 65 |
| 2" | 81 |

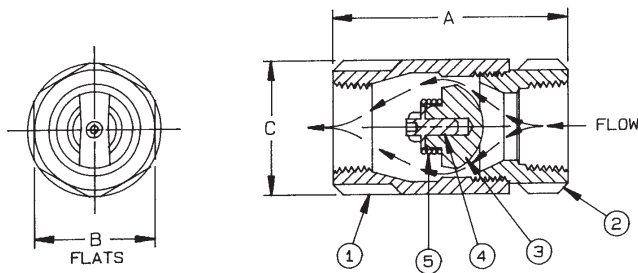

Dimensional Specifications

| Number | Size | A | B | C | Wt./100 |
|-----------|--------|------|------|------|---------|
| 62-101-01 | 1/4" | 2.06 | 1.12 | 1.12 | 38 |
| 62-102-01 | 3/8" | 2.12 | 1.12 | 1.12 | 38 |
| 62-103-01 | 1/2" | 2.31 | 1.12 | 1.12 | 38 |
| 62-104-01 | 3/4" | 2.87 | 1.37 | 1.50 | 75 |
| 62-105-01 | 1" | 3.50 | 1.75 | 1.93 | 145 |
| 62-106-01 | 1 1/4" | 4.18 | 2.12 | 2.37 | 237 |
| 62-107-01 | 1 1/2" | 4.93 | 2.50 | 2.81 | 381 |
| 62-108-01 | 2" | 6.00 | 3.00 | 3.68 | 636 |

RTE Ball Cone Check

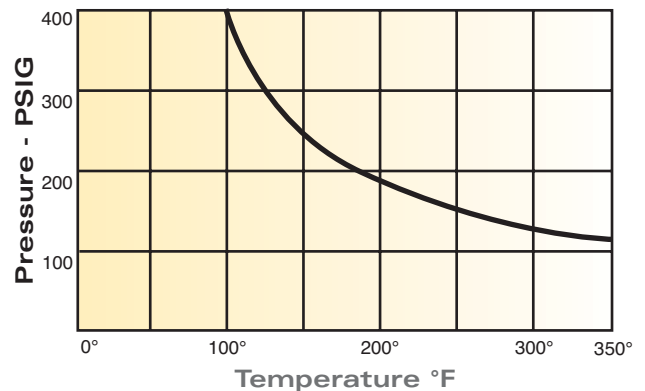

**62-500 Series
Stainless Steel
Check Valves**

**Female x Female Threaded
1/4" through 1"**

Perfect for lower flow applications in tough industrial environments, since seat disc and soft seat are less prone to vibration. The stainless steel body and check provide lasting protection against reverse flow.



Features

The 62-500 features a Fluorocarbon (Viton®) soft seat for bubble tight shutoff, reduced noise and vibration. It is spring-loaded for fast seating action and center guided so that radial alignment is never needed. Straight-through flow minimizes velocity change. The spring is fully protected from the flow stream, helping extend the life of the valve. A light spring is available as an option. The 62-500 is rated 400 psig CWP, cold non-shock; Maximum Temperature 350°F.

Flow Rate (Cv)
GPM=gallons per minute
all at 1 psi pressure differential

| Size | GPM |
|------|------|
| 1/4" | 0.47 |
| 3/8" | 1.57 |
| 1/2" | 2.20 |
| 3/4" | 4.78 |
| 1" | 6.00 |

Materials of Construction

| | | |
|---|----------|-----------------------------------|
| 1 | Body | Stainless Steel - ASTM A351, CF8M |
| 2 | Retainer | Stainless Steel - ASTM A276, 316 |
| 3 | Seat | Fluorocarbon Rubber-Viton® |
| 4 | Spring | Stainless Steel - AISI 316 |
| 5 | Check | Stainless Steel - ASTM A276, 316 |

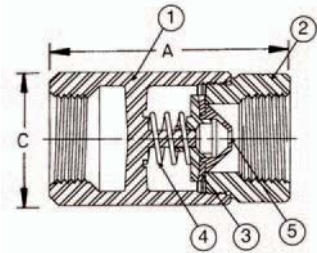
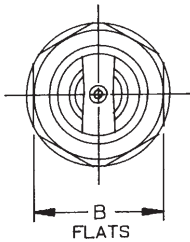

Dimensional Specifications

| Number | Size (in.) | A | B | C | Wt./100 |
|-----------|------------|------|------|------|---------|
| 62-501-01 | 1/4 | 2.31 | 1.12 | 1.12 | 38 |
| 62-502-01 | 3/8 | 2.31 | 1.12 | 1.12 | 38 |
| 62-503-01 | 1/2 | 2.31 | 1.12 | 1.12 | 38 |
| 62-504-01 | 3/4 | 2.87 | 1.37 | 1.50 | 75 |
| 62-505-01 | 1 | 3.50 | 1.75 | 1.93 | 145 |

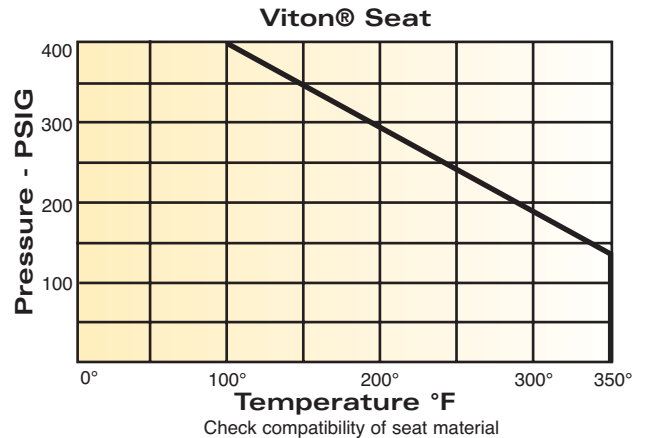

Repair Kits

61-100 Repair Kits

| Repair Kit Part Number | Size (in.) | Check Valve Part Number |
|------------------------|------------|-------------------------|
| 61-001-01 | 1/4 | 61-101-01 |
| 61-002-01 | 3/8 | 61-102-01 |
| 61-003-01 | 1/2 | 61-103-01 |
| 61-004-01 | 3/4 | 61-104-01 |
| 61-005-01 | 1 | 61-105-01 |
| 61-006-01 | 1-1/4 | 61-106-01 |
| 61-007-01 | 1-1/2 | 61-107-01 |
| 61-008-01 | 2 | 61-108-01 |
| 61-009-01 | 2-1/2 | 61-109-01 |
| 61-010-01 | 3 | 61-100-01 |

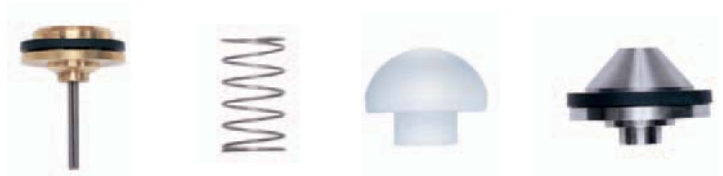

61-200 Repair Kits

| Repair Kit Part Number | Size (in.) | Check Valve Part Number |
|------------------------|------------|-------------------------|
| 61-001-01 | 1/4 | 61-201-01 |
| 61-002-01 | 3/8 | 61-202-01 |
| 61-003-01 | 1/2 | 61-203-01 |
| 61-004-01 | 3/4 | 61-204-01 |
| 61-005-01 | 1 | 61-205-01 |
| 61-006-01 | 1-1/4 | 61-206-01 |
| 61-007-01 | 1-1/2 | 61-207-01 |
| 61-008-01 | 2 | 61-208-01 |

61-500 Repair Kits

| Repair Kit Part Number | Size | Check Valve Part Number |
|------------------------|-------|-------------------------|
| 61-901-01 | 1/4 | 61-501-01 |
| 61-902-01 | 3/8 | 61-502-01 |
| 61-903-01 | 1/2 | 61-503-01 |
| 61-904-01 | 3/4 | 61-504-01 |
| 61-905-01 | 1 | 61-505-01 |
| 61-906-01 | 1-1/4 | 61-506-01 |
| 61-907-01 | 1-1/2 | 61-507-01 |
| 61-908-01 | 2 | 61-508-01 |

61-600 Repair Kits

| Repair Kit Part Number | Size (in.) | Check Valve Part Number |
|------------------------|------------|-------------------------|
| 61-903-01 | 1/2 | 61-603-01 |
| 61-904-01 | 3/4 | 61-604-01 |
| 61-905-01 | 1 | 61-605-01 |
| 61-906-01 | 1-1/4 | 61-606-01 |
| 61-907-01 | 1-1/2 | 61-607-01 |
| 61-908-01 | 2 | 61-608-01 |

62-100 Repair Kits

| Repair Kit Part Number | Size (in.) | Check Valve Part Number |
|------------------------|------------|-------------------------|
| 62-001-01 | 1/4 | 62-101-01 |
| 62-002-01 | 3/8 | 62-102-01 |
| 62-003-01 | 1/2 | 62-103-01 |
| 62-004-01 | 3/4 | 62-104-01 |
| 62-005-01 | 1 | 62-105-01 |
| 62-006-01 | 1-1/4 | 62-106-01 |
| 62-007-01 | 1-1/2 | 62-107-01 |
| 62-008-01 | 2 | 62-108-01 |

62-500 Repair Kits

| Repair Kit Part Number | Size (in.) | Check Valve Part Number |
|------------------------|------------|-------------------------|
| 62-901-01 | 1/4 | 62-501-01 |
| 62-902-01 | 3/8 | 62-502-01 |
| 62-903-01 | 1/2 | 62-503-01 |
| 62-904-01 | 3/4 | 62-504-01 |
| 62-905-01 | 1 | 62-505-01 |

Other Conbraco Literature For Your Specification Library



Water Pressure Reducing
Valves Brochure

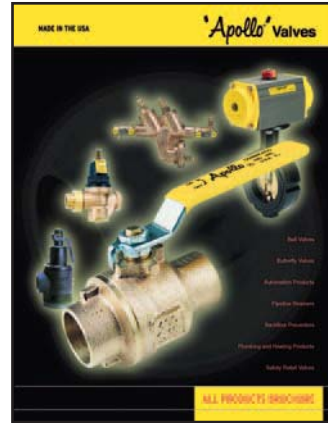

All Products Brochure

To learn more about Conbraco In-Line Check Valves, or to place and order, see your Conbraco distributor. Or contact Conbraco's Customer Service Department. Phone (704) 841-6000; Fax (704) 841-6020.

"Apollo" Valves
Manufactured by Conbraco Industries Inc.

Conbraco Industries, Inc.
P.O. Box 247
Matthews, NC 28106
(704) 841-6000
Fax: (704) 841-6020
www.apollovalves.com

Your local Conbraco distributor is:

