

In-Line Check Valves

In-Line Check Valves

CVB (61-100 & 61-200) SERIES



BALL CONE® CHECK VALVES

Patented design (U.S. Pat. No. 4,172,465) with reinforced RPTFE ball-cone check and stainless steel springs, these valves offer reliable protection against reverse flow and exceptional resistance to chemicals and corrosion. No radial alignment is needed.

FEATURES

- 1/2" psi opening pressure
- Bronze sizes from 1/4" to 3"
- Tight shut-off with liquid media
- 400 psig CWP
- 125 psig steam rating @ 350°F max
- 61LF Lead Free* option
- Straight-through design minimizes velocity changes
- ASTM B584 Bronze
- American-made construction
- Numerous options are available

Check Valve Part Numbering System

6 X - X X X - X X

TYPE	CHECK	SPRING TYPE	SIZE	OPTIONS
1-Brass	1-Ball Cone (NPT-F x F)	0-.5 psig Cracking Pressure	1-1/4"	01 - Standard
2-Stainless Steel	2-Ball Cone (NPT-M x F)	2-.2 psig Cracking Pressure	2-3/8"	011 - International 1/2 BSP
	5-Soft Seat (NPT-F x F)		3-1/2"	17 - Satin Chrome Plated
	6-Soft Seat (Sweat F x F)		4-3/4"	21 - BSPP Thread
	9-Soft Seat Repair Kit (EPR only)		5-1"	57 - Oxygen Cleaned
	0-Ball Cone Repair Kit		6-1-1/4"	A1 - Less Spring
			7-1-1/2"	A8 - No Pipe Thread Retainer End
			8-2"	B1 - Nitrile Seat (Soft Seat Only)
			9-2-1/2"	E05 - 5 psig Opening Pressure*
			0-3"	E10 - 10 psig Opening Pressure*

*Available in 1/4" through 1" Only.
(Note: Not all combinations are available. Contact Customer Service for verification.)

Flow Rate (C _v)	GPM
1/4"	0.85
3/8"	1.21
1/2"	1.4
3/4"	3.53
1"	6
1-1/4"	44
1-1/2"	65
2"	81
2-1/2"	175
3"	265

Pressure Temperature Ratings	Degree (F)	PSIG
-20 to 100		400
200		200
250		160
275		150
300		140
325		130
353		125

Bronze		Bronze		Dimensions (in.)			61 Series	62 Series
FNPT x FNPT	MNPT x FNPT	Size	A	B	C	Wt./100	Wt./100	
61-101-01	61-201-01	1/4	2.06	1.12	1.12	38.0	38.3	
61-102-01	61-202-01	3/8	2.12	1.12	1.12	38.0	37.3	
61-103-01	61-203-01	1/2	2.31	1.12	1.12	38.0	36.3	
61-104-01	61-204-01	3/4	2.87	1.37	1.50	75.0	76.6	
61-105-01	61-205-01	1	3.50	1.75	1.93	145.0	145.0	
61-106-01	61-206-01	1 1/4	4.18	2.12	2.37	275.0	237.5	
61-107-01	61-207-01	1 1/2	4.93	2.50	2.81	394.0	381.3	
61-108-01	61-208-01	2	6.00	3.00	3.68	630.0	636.0	
61-109-01	-	2 1/2	7.00	3.50	4.50	1400.0	-	
61-100-01	-	3	8.12	4.12	5.31	1665.0	-	

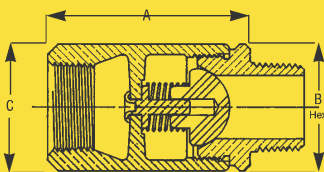
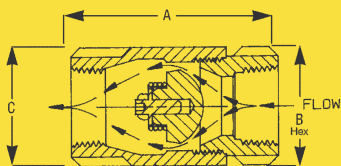

Precautionary Note

Not recommended for use with reciprocating pumps and similar applications which may induce repetitious vibrations. Low flow rates which do not fully open the valve, may result in undesirable noise and premature valve failure. Upstream flow disturbances, which create turbulence, may also result in rapid wear. Therefore, it is recommended that a minimum of 10 diameters of straight pipe be provided between the check valve and any upstream flow disturbances such as pumps, control valves, elbows, etc.

In-Line Check Valves

In-Line Check Valves

CVS (62-100) SERIES

STAINLESS STEEL BALL CONE® CHECK VALVES

The 62-100 Series is uniquely suited for applications in corrosive environments, including chemical processing, pulp and paper and other process industries. The rugged stainless steel body and RPTFE ball check provide reliable, patented protection against reverse flow.

FEATURES

- Female x Female Threaded 1/4" through 2"
- Unique (U.S. Patent # 4,172,465) design
- Longer life in severe environments
- Spring-loaded for fast seating action
- Center guided so that radial alignment is never needed
- Straight-through flow minimizes velocity change
- Rated 400 psig CWP non-shock
- RoHS Compliant



Part Number	Size (in.)	Dimensions (in.)			Wt./100 (lbs.)
		A	B	C	
62-101-01	1/4	2.06	1.12	1.12	38
62-102-01	3/8	2.12	1.12	1.12	38
62-103-01	1/2	2.31	1.12	1.12	38
62-104-01	3/4	2.87	1.37	1.50	75
62-105-01	1	3.50	1.75	1.93	145
62-106-01	1-1/4	4.18	2.12	2.37	237
62-107-01	1-1/2	4.93	2.50	2.81	381
62-108-01	2	6.00	3.00	3.68	636

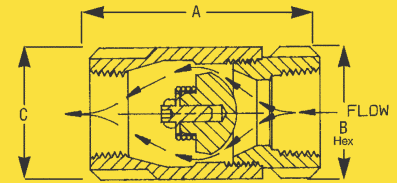

SOFT SEAT CHECK VALVES

Fabricated with stainless steel springs and elastomeric seats for tighter shut-off. No radial alignment is needed. Exceptional resistance to chemicals and corrosion.

FEATURES

- Female NPT sizes: 1/4" to 2"
- Stainless steel sizes: 1/4" to 1"
- Bubble-tight shut-off, ideally suited for gaseous service
- NPT threaded; 400 psig CWP non-shock
- EPDM check disc
- SS check features Viton® check disc
- Straight-through design minimizes velocity changes
- Approximate opening pressure 1/2 psi
- Numerous options are available
- RoHS Compliant (62 Series)

CVBE & CVSE (61-500 & 62-500) SERIES



Bronze		SS		Dimensions (in.)			61 Series	62 Series
FNPT x FNPT	FNPT x FNPT	Size(in.)	A	B	C	Wt./100	Wt./100	
61-501-01	62-501-01	1/4	2.312	1.125	1.125	38	38	
61-502-01	62-502-01	3/8	2.312	1.125	1.125	38	38	
61-503-01	62-503-01	1/2	2.312	1.125	1.125	38	38	
61-504-01	62-504-01	3/4	2.875	1.375	1.500	75	75	
61-505-01	62-505-01	1	3.500	1.750	1.937	145	150	
61-506-01	-	1-1/4	4.187	2.125	2.375	275	-	
61-507-01	-	1-1/2	4.937	2.500	2.812	394	-	
61-508-01	-	2	6.000	3.000	3.687	630	-	

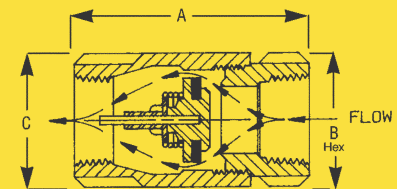

Precautionary Note

Not recommended for use with reciprocating pumps and similar applications which may induce repetitious vibrations. Low flow rates which do not fully open the valve may result in undesirable noise and premature valve failure. Upstream flow disturbances, which create turbulence, may also result in rapid wear. Therefore, it is recommended that a minimum of 10 diameters of straight pipe be provided between the check valve and any upstream flow disturbances such as pumps, control valves, elbows, etc.

In-Line Check Valves

In-Line Check Valves

CVBES (61-600) SERIES

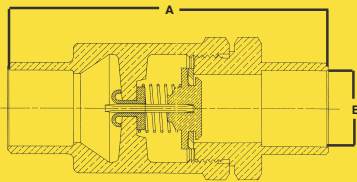

SOLDER END SOFT SEAT CHECK VALVES

All bronze with stainless steel springs and elastomeric seats for tighter shut-off. No radial alignment is needed. Exceptional resistance to corrosion.

FEATURES

- Sizes: 1/2" to 2"
- Bubble-tight shut-off, ideally suited for gaseous service
- Straight-through design minimizes velocity changes
- Solder end; 400 psig CWP non-shock
- Approximate opening pressure 1/2 psi
- Max Temperature 250°F
- Numerous options are available

Part Number	Size (in.)	Dimensions (in.)			Wt./100 (lbs.)
		A	B	C	
61-603	1/2	2.72	.629	1.25	50
61-604	3/4	3.67	.881	1.65	86
61-605	1	4.48	1.13	2.10	171
61-606	1-1/4	6.11	1.38	2.38	275
61-607	1-1/2	6.87	1.63	2.81	394
61-608	2	7.46	2.13	3.75	630

CV (61-700) SERIES

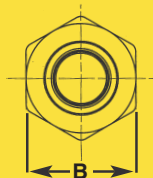
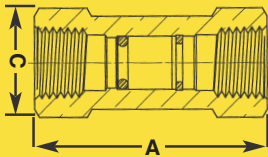

BRASS NPT "MINI" CHECK VALVES

Ideally suited for all OEM applications where space is a premium. Excellent for use on water and air. Features a bubble-tight soft seat design with a very light loaded stainless steel spring. It is rated at 250 psig WOG with a maximum temperature of 180°F.

FEATURES

- Sizes: 1/4" to 1"
- FNPT x FNPT
- Check valve material acetyl silicone
- Low lead body - B16 brass
- Check opening pressure is .5 psi
- MSS-SP80 compliant

Part Number	Size (in.)	Dimensions (in.)			Wt./100 (lbs.)
		A	B	C	
61-701-01	1/4	1.72	0.81	0.92	22
61-702-01	3/8	1.79	0.93	1.05	29
61-703-01	1/2	2.02	1.06	1.17	38
61-704-01	3/4	2.50	1.25	1.40	54
61-705-01	1	2.95	1.62	1.76	110

Precautionary Note

Not recommended for use with reciprocating pumps and similar applications which may induce repetitious vibrations. Low flow rates which do not fully open the valve may result in undesirable noise and premature valve failure. Upstream flow disturbances, which create turbulence, may also result in rapid wear. Therefore, it is recommended that a minimum of 10 diameters of straight pipe be provided between the check valve and any upstream flow disturbances such as pumps, control valves, elbows, etc.